

## 400 Line 1 Door Freezer- Stainless steel

ITEM # \_\_\_\_\_

MODEL # \_\_\_\_\_

NAME # \_\_\_\_\_

SIS # \_\_\_\_\_

AIA # \_\_\_\_\_



### 400 Line

#### 1 Door Freezer- Stainless steel

110282 (Z4FSF4)

1-door freezer 400lt, -15-24°C,  
stainless steel

### Short Form Specification

#### Item No. \_\_\_\_\_

Exterior in stainless steel. Interior in white High Impact Polystyrene with rounded corners and 45mm thick insulation. Right hinged full door with lock and heated frame, reversible on-site. Built-in refrigeration unit; manual defrost; digital control and temperature display; multiple evaporating grids. For ambient temperatures up to 38 °C. HCFC, CFC and HFC free insulation and R404a refrigerant gas.  
Supplied with n. 4 evaporating grids.

### Main Features

- Digital control panel allowing the easy and precise setting and control of the internal temperature.
- Shelf runners are thermoformed and are incorporated in the internal structure to be easily cleanable.
- CFC and HCFC free (ecological refrigerant type: R404a, gas in foam: cyclopentane).
- Whole interior cell with rounded corners is white thermoformed polystyrene, which is impact resistant.
- Model requires only 1 phase 230V supply and can be plugged straight into an existing power socket.
- Very quiet operation.
- No joints whatsoever to eliminate dirt traps.
- Simple refrigeration system easily accessible from the rear of the units.

### Construction

- Developed and produced in ISO 9001 and ISO 14001 certified factory.
- All models in range are finished in top quality materials to aid durability.

### Optional Accessories

- Kit of wheels for 400lt refrigerators PNC 880348 ☐
- 2 wheels (one with brake) PNC 880539 ☐
- Pvc container with false bottom for 400 lt cabinets PNC 881072 ☐
- Printer for HACCP basic version (for cabinets and counters with digital control) PNC 881457 ☐

APPROVAL: \_\_\_\_\_

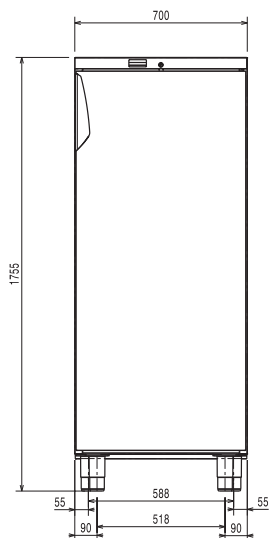
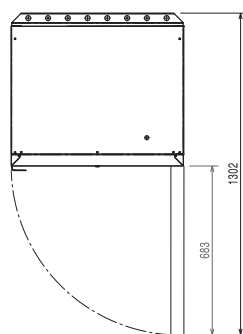
**Front**

**Top**

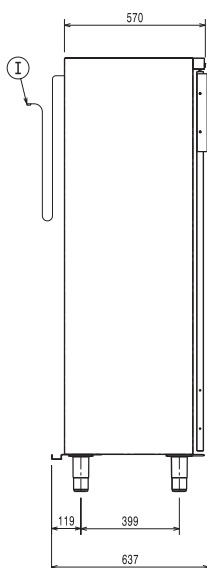
**EI** = Electrical inlet (power)  
**RI** = Refrigerant Inlet  
**RO** = Refrigerant Outlet

**Side**

**Electric**

Supply voltage:  
 110282 (Z4FSF4) 230 V/1N ph/50 Hz  
 Electrical power max.: 0.53 kW

**Key Information:**

Gross capacity: 400 lt  
 Door hinges: Right Side  
 External dimensions, Height: 1755 mm  
 External dimensions, Width: 700 mm  
 External dimensions, Depth with Doors Open: 1310 mm  
 Noise level: 56 dBA  
 Number and type of grids (included): - 600x400  
 Type of external material: Stainless Steel  
 External door material: Stainless Steel

**Refrigeration Data**

Control type: Digital  
 Compressor power: 1/2 hp  
 Refrigerant type: R404a  
 Refrigeration power: 780 W  
 Refrigeration power at evaporation temperature: -29 °C  
 Refrigerant weight: 240 g  
 Operating temperature min.: -24 °C  
 Operating temperature max.: -15 °C  
 Operating mode: Static  
 Cooling unit: Built-In  
 Defrost type: Manual