

User Guide



PREPARATION

- CHECK THE **DRAIN PLUG** IS PUSHED FIRMLY IN PLACE AND **FILTERS** ARE PROPERLY SECURED.
- CHECK THE **DETERGENT** CHEMICAL (RED) AND **RINSE AID** CHEMICAL (CLEAR) SUPPLY TUBES - WITH **FOOT VALVES** - ARE SUBMERGED IN SUFFICIENT PRODUCT.
- CHECK THE DOOR IS CLOSED AND PRESS THE **POWER SWITCH** - THE GREEN **POWER LAMP** WILL COME ON.
- WAIT FOR THE MACHINE TO FILL WITH WATER AND REACH THE CORRECT WASHING TEMPERATURE. THE **MACHINE READY LAMP** WILL COME ON.

OPERATION

- REMOVE ALL DEBRIS FROM THE GLASSES TO BE WASHED BEFORE PLACING THEM INTO THE BASKET. PUSH THE BASKET INTO THE MACHINE.
- CLOSE THE DOOR - PRESS THE **CYCLE START SWITCH** - THE WASHING CYCLE WILL BEGIN AND THE **WASH CYCLE LAMP** WILL COME ON.
- AT THE END OF THE CYCLE THE **WASH CYCLE LAMP** WILL GO OUT - OPEN THE DOOR AND PULL OUT THE BASKET.
- ALLOW EXCESS WATER TO RUN OFF BEFORE REMOVING THE BASKET.

DAILY CLEANING & MAINTENANCE

- AT THE END OF A SESSION TURN OFF THE **POWER SWITCH**. DO NOT REMOVE THE **FILTER** AT THIS STAGE.
- REMOVE THE **DRAIN PLUG** - THE WASH TANK WILL EMPTY - (MACHINES FITTED WITH DRAIN PUMP WILL AUTOMATICALLY START TO PUMP THE WATER OUT).
- COLLECT THE DEBRIS AND REMOVE FROM THE WASH TANK.
- CLEAN AROUND THE WASH TANK - DOOR SURROUNDS AND HINGES WITH AN 'ADDIS' TYPE WASHING UP BRUSH AND CLEANING CLOTH.
- DO NOT USE BLEACH OR CHLORIDE BASED CLEANING SOLUTIONS OR ABRASIVES WHEN CLEANING THE WASH TANK.
- TAKE OUT THE **FILTER BOWL** - CLEAN THOROUGHLY AND REPLACE .
- DO NOT ALLOW DEBRIS TO GO DOWN THROUGH THE **OUTLET HOLE** AS THIS MAY DAMAGE YOUR MACHINE.
- REGULARLY CHECK **RINSE JETS** AND **WASH JETS** ARE CLEAR OF DEBRIS OR LIME SCALE - REMOVE IF NECESSARY BY UNSCREWING THE **RINSE ARM NUT** THAT HOLDS THE **RINSE ARM** IN PLACE - REMOVE THE **RINSE PIN** THAT HOLDS THE **WASH ARM** IN PLACE - CLEAN BOTH THOROUGHLY AND REASSEMBLE.

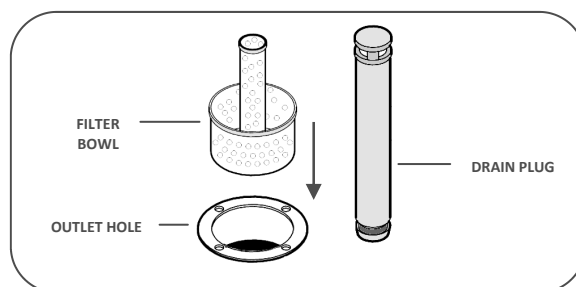
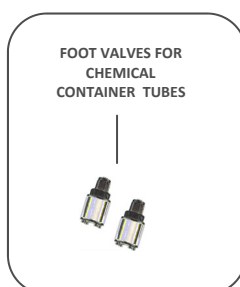
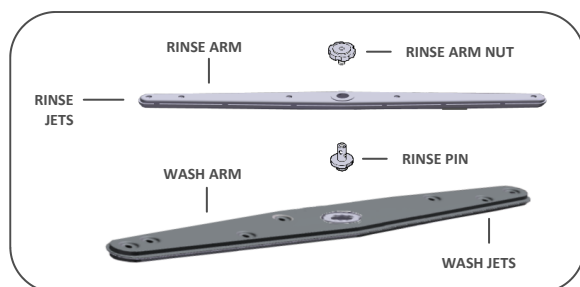

SERVICE CALLS TO RECTIFY FAULTS CAUSED BY 'THE LACK OF ROUTINE MAINTENANCE' WILL BE CHARGED FOR AND YOUR WARRANTY MAY BE AFFECTED



PREPARATION

- CHECK THE **DRAIN PLUG** IS PUSHED FIRMLY IN PLACE AND **FILTERS** ARE PROPERLY SECURED.
- CHECK THE **DETERGENT** CHEMICAL (RED) AND **RINSE AID** CHEMICAL (CLEAR) SUPPLY TUBES - WITH **FOOT VALVES** - ARE SUBMERGED IN SUFFICIENT PRODUCT.
- CHECK THE DOOR IS CLOSED AND PRESS THE **POWER SWITCH** - THE GREEN **POWER LAMP** WILL COME ON.
- WAIT FOR THE MACHINE TO FILL WITH WATER AND REACH THE CORRECT WASHING TEMPERATURE. THE **MACHINE READY LAMP** WILL COME ON.

OPERATION

- REMOVE ALL DEBRIS FROM THE GLASSES TO BE WASHED BEFORE PLACING THEM INTO THE BASKET. PUSH THE BASKET INTO THE MACHINE.
- CLOSE THE DOOR - PRESS THE **CYCLE START SWITCH** - THE WASHING CYCLE WILL BEGIN AND THE **WASH CYCLE LAMP** WILL COME ON.
- AT THE END OF THE CYCLE THE **WASH CYCLE LAMP** WILL GO OUT - OPEN THE DOOR AND PULL OUT THE BASKET.
- ALLOW EXCESS WATER TO RUN OFF BEFORE REMOVING THE BASKET.

DAILY CLEANING & MAINTENANCE

- AT THE END OF A SESSION TURN OFF THE **POWER SWITCH**. DO NOT REMOVE THE **FILTER** AT THIS STAGE.
- REMOVE THE **DRAIN PLUG** - THE WASH TANK WILL EMPTY - (MACHINES FITTED WITH DRAIN PUMP WILL AUTOMATICALLY START TO PUMP THE WATER OUT).
- COLLECT THE DEBRIS AND REMOVE FROM THE WASH TANK.
- CLEAN AROUND THE WASH TANK - DOOR SURROUNDS AND HINGES WITH AN 'ADDIS" TYPE WASHING UP BRUSH AND CLEANING CLOTH.
- DO NOT USE BLEACH OR CHLORIDE BASED CLEANING SOLUTIONS OR ABRASIVES WHEN CLEANING THE WASH TANK.
- TAKE OUT THE **FILTER BOWL** - CLEAN THOROUGHLY AND REPLACE .
- DO NOT ALLOW DEBRIS TO GO DOWN THROUGH THE **OUTLET HOLE** AS THIS MAY DAMAGE YOUR MACHINE.
- REGULARLY CHECK **RINSE JETS** AND **WASH JETS** ARE CLEAR OF DEBRIS OR LIME SCALE - REMOVE IF NECESSARY BY UNSCREWING THE **RINSE ARM NUT** THAT HOLDS THE **RINSE ARM** IN PLACE - REMOVE THE **RINSE PIN** THAT HOLDS THE **WASH ARM** IN PLACE - CLEAN BOTH THOROUGHLY AND REASSEMBLE.

WATER SOFTENER REGENERATION

- THE **SALT LOW LAMP** WHEN ON WARNS IF THE SALT CONTAINER IS EMPTY.
- UNSCREW THE **SALT CONTAINER LID** LOCATED INSIDE THE WASH TANK AND FILL WITH GRANULAR CATERING SALT (THE SALT CONTAINER WILL APPROXIMATELY REGENERATE FOUR REGENERATION CYCLES & HOLDS 500g OF SALT).DO NOT OVERSPILL, ENSURE THE **SALT CONTAINER LID** IS SECURE AFTER FILLING.
- THE REGENERATION CYCLE SHOULD BE STARTED AT THE END OF THE SERVICE WHEN THE MACHINE HAS BEEN IN USE, REMOVE THE **DRAIN PLUG** FROM THE WASH TANK. THE WASH TANK WILL EMPTY. (THE **DRAIN PLUG** SHOULD BE REMOVED DURING THE 20 MINUTES REGENERATION)
- TURN THE MACHINE OFF. THE MACHINE **POWER SWITCH** MUST BE OFF TO ENABLE THE REGENERATION CYCLE SWITCH.
- CLOSE THE HOOD AND PRESS THE **REGENERATION SWITCH** FOR TWO SECONDS, THE **WATER SOFTENER REGENERATION LAMP** WILL COME ON.
- THE REGENERATION OF THE WATER SOFTENER WILL TAKE AROUND 20 MINUTES AND WILL BE FULLY AUTOMATIC.
- THE **WATER SOFTENER REGENERATION LAMP** WILL GO OUT AND THE MACHINE WILL SWITCH OFF AUTOMATICALLY AFTER THE REGENERATION CYCLE IS COMPLETE. REMEMBER TO REPLACE THE **DRAIN PLUG** BEFORE RE-FILLING THE MACHINE.
- MEDIUM-WATER HARDNESS MAY REQUIRE FOUR REGENERATIONS A WEEK. MEDIUM TO HARD-WATER HARDNESS MAY REQUIRE DAILY REGENERATION.

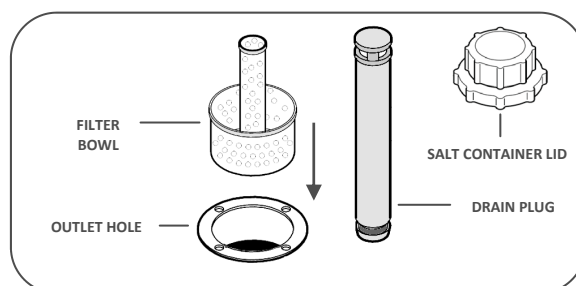
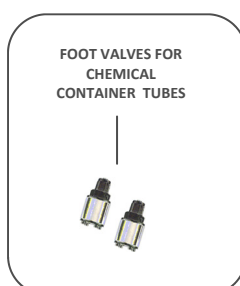
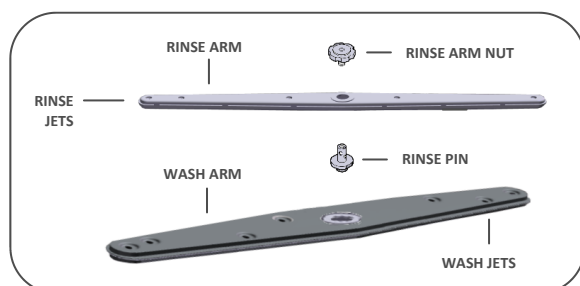

SERVICE CALLS TO RECTIFY FAULTS CAUSED BY 'THE LACK OF ROUTINE MAINTENANCE' WILL BE CHARGED FOR AND YOUR WARRANTY MAY BE AFFECTED