

imc

fresh thinking

Technical Information Food Waste Disposers



April 2005
(UK Version)

Overview

Best practice dictates the removal of food waste quickly and completely from commercial kitchens, eliminating unpleasant odours and spillages, and the risk of contaminating fresh or cooked food. Food waste disposers are essential for the efficient and hygienic removal of preparation waste and table scraps.

IMC food waste disposers are safe and easy to use, and offer unique features and enhanced performance and reliability.

The range of installation options available from IMC ensures that the needs of every caterer can easily be met. For the range summary and appropriate food waste disposer please see the IMC product selector. All IMC food waste disposers can be fitted to a Mechline services box.

Electrical Connection

All electrical work must be carried out by a qualified electrician in accordance with the IEE Codes of Practice.

Product Conformity

IMC food waste disposers conform to the Machine Safety Directive 89/392/EEC as amended by 91/368/EEC and 93/44/EEC and are manufactured under quality system BSEN ISO 9001:2000. They also conform to the protection requirements of the Electro Magnetic Compatibility Directive 89/336/EEC and are manufactured in accordance with harmonised standards EN 50-014-1 Generic Emission and EN 50-014-2 Generic Immunity (plus product specific standards). They also satisfy the essential requirements of the Low Voltage Directive 73/23/EEC amended by 93/68/EEC.

All IMC food waste disposers are WRAS approved and manufactured in accordance with standards BSEN 60335-1 and BSEN 60335-2-16.

Marine Applications

A wide range of marine voltages are available. IMC food waste disposers meet the requirements of regulation 3(1)(c), 4(2) and 5(2)(c) of Annex V of MARPOL 73/78.

Warranty

IMC food waste disposers come with one year parts and labour warranty. (subject to usage and regular maintenance as laid down in the operation and installation manual).

Spare Parts

Spare parts are available for all major serviceable items. Please contact:

IMC service telephone: +44 (0)1923 718017
 IMC spares telephone: +44 (0)1923 718018
 Fax: +44 (0)1923 896256
 E-mail: parts@imco.co.uk

Product Selector

Use this simple guide to select the best IMC food waste disposer for your requirements.

Covers per sitting	200	400	400	400	850	850	1000	1350	1350	1450	1450	1850
Waste per hour (Kg)	100	200	200	250	400	400	500	600	600	700	700	900
Soft Waste: (Plate waste, vegetables, peelings, meat and fish scraps.)	✓	✓	✓	✓	✓	✓	✓	✓	✓	✓	✓	✓
Medium Waste: (Small pork and chicken bones, vegetables and fruit.)				✓	✓	✓	✓	✓	✓	✓	✓	✓
Tough Waste: (All red meat bones, cauliflower stalks, fish skins.)								✓	✓	✓	✓	✓
Compatible with WastePro		✓	✓	✓	✓	✓	✓	✓	✓	✓	✓	
Compatible with Troughs							✓				✓	✓
Motor kW	0.55	0.55	0.55	1.1	1.1	1.1	1.1	2.2	2.2	2.2	2.2	4
Motor HP	3/4	3/4	3/4	1 1/2	1 1/2	1 1/2	1 1/2	3	3	3	3	5 1/2
Mounting	Under Sink	In Tabling	Free Standing	Under Sink	In Tabling	Free Standing	Free Standing or in Tabling	In Tabling	Free Standing	Free Standing	Free Standing or in Tabling	Free Standing or in Tabling
Model	523	525	526	723	725	726	904(X)	825	826	825DS	1204(X)	1604(X)
Refer to Page No	3	3	4	5	5	6	9/10	7	7	8	11/12	13/14

Please note: All capacities are approximate and may vary depending on the mix of waste types. Rice and pasta must be mixed well with other food wastes.

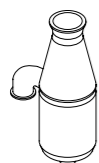

523	
General	
Mounting	Sink outlet. Supplied with fitting for 89mm (3.5") sink opening.
Capacity	200 covers per sitting. 100kg of waste per hour.
Dimensions	h406mm. Fits 89mm (3.5") sink opening.
Cut out dimensions	-
Electrical information	
Motor	0.55 kW (3/4HP)
Voltages	230-1-50 400-3-50
Fuse rating	16A - 1 phase 6A - 3 phase
Operator controls	IP65 rated waterproof wall mounted control box. Motor on buttons (clockwise and anticlockwise) and off button.
Installation information	
Water connection	Sink tap.
Water consumption	11-14 litres per minute
Waste connection	40mm copper or plastic pipe to be installed with P or S trap laid to minimum fall of 1 in 7.
Electrical connection	2.5m of mains cable. Supplied from control box, to be wired into fused isolator switch.
Other features	
Water control	Manual with sink taps.
Operator safety	Rubber petals at sink opening.
Special features	Rubber housing to minimise noise. Automatic thermal overload to protect the motor. Manually reversible motor for extended operating life.
Customer options	
-	
Product code details	
F52/301	1 phase 523
F52/321	3 phase 523
Shipping specification	
Packing dimensions (h x w x d)	320mm x 220mm x 620mm
Packing volume	0.043m ³
Packing weight (gross/net)	19kg/18kg

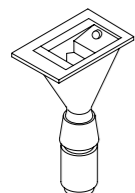
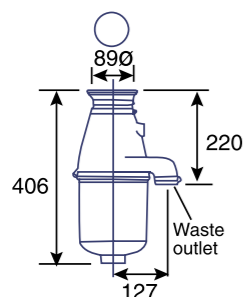

525	
General	
Mounting	Weld into tabling.
Capacity	400 covers per sitting. 200kg of waste per hour.
Dimensions (h x w x d)	630mm x 330mm x 355mm
Cut out dimensions	-
Electrical information	
Motor	0.55 kW (3/4 HP)
Voltages	230-1-50 400-3-50
Fuse rating	16A - 1 phase 6A - 3 phase
Operator controls	IP65 rated waterproof wall mounted control box. Motor on buttons (clockwise and anticlockwise) and off button.
Installation information	
Water connection	15mm connection. Minimum pressure (head) of 0.4 bar (4m). Water to be taken from storage cistern and not from rising main to meet UK water regulations.
Water consumption	11-14 litres per minute.
Waste connection	42mm copper or plastic pipe to be installed with P or S trap laid to minimum fall of 1 in 7.
Electrical connection	2.5m of mains cable supplied from control box, to be wired into fused isolator switch.
Other features	
Water control	Solenoid valve for automatic water control.
Operator safety	Metal baffle and time delayed interlock system.
Special features	Rubber housing to minimise noise. Automatic thermal overload to protect the motor. Manually reversible motor for extended operating life.
Customer options	
-	
Product code details	
F52/500	1 phase 525
F52/520	3 phase 525
Shipping specification	
Packing dimensions (h x w x d)	770mm x 410mm x 510mm
Packing volume	0.161m ³
Packing weight (gross/net)	30kg/28kg

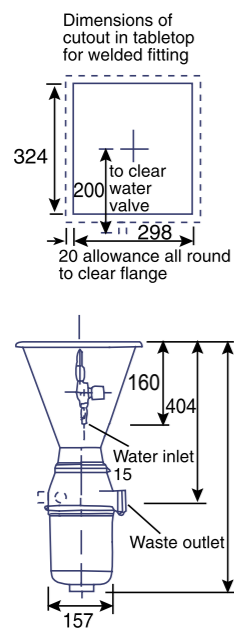

* All diagram dimensions are in mm

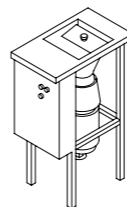

526	
General	
Mounting	Free standing with stainless steel front panel.
Capacity	400 covers per sitting. 200kg of waste per hour.
Dimensions (h x w x d)	865mm x 400mm x 600mm
Cut out dimensions	-
Electrical information	
Motor	0.55 kW (3/4HP)
Voltages	230-1-50 400-3-50
Fuse rating	16A - 1 phase 6A - 3 phase
Operator controls	IP65 rated waterproof integral controls. Motor on buttons (clockwise and anticlockwise) and off button.
Installation information	
Water connection	15mm connection. Minimum pressure (head) of 0.4 bar (4m). Water to be taken from storage cistern and not from rising main to meet UK water regulations.
Water consumption	11-14 litres per minute.
Waste connection	42mm copper or plastic pipe to be installed with P or S trap laid to minimum fall of 1 in 7.
Electrical connection	2.5m of mains cable supplied from control box, to be wired into fused isolator switch.
Other features	
Water control	Solenoid valve for automatic water control.
Operator safety	Metal baffle and time delayed interlock system.
Special features	Rubber housing to minimise noise. Automatic thermal overload to protect the motor. Manually reversible motor for extended operating life.
Customer options	
Stainless steel side panels.	
Product code details	
F52/602	1 phase 526
F52/622	3 phase 526
E35/056	Stainless steel side panel 526
Shipping specification	
Packing dimensions (h x w x d)	680mm x 580mm x 1020mm
Packing volume	0.402m ³
Packing weight (gross/net)	50kg/36kg

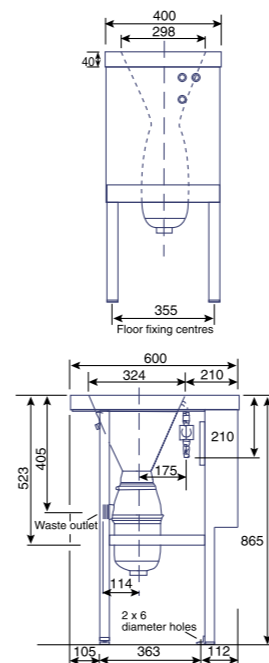

* All diagram dimensions are in mm

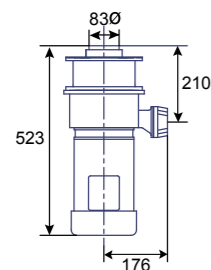
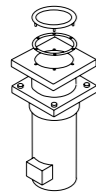

723	
General	
Mounting	Sink outlet. Supplied with fitting to be welded into 86mm sink opening.
Capacity	400 covers per sitting. 200kg of waste per hour.
Dimensions	h530mm. Fits 83mm sink opening.
Cut out dimensions	-
Electrical information	
Motor	1.1kW (1½HP)
Voltages	230-1-50 400-3-50
Fuse rating	16A - 1 phase 6A - 3 phase
Operator controls	IP65 rated waterproof wall mounted control box. Motor on buttons (clockwise and anticlockwise) and off button.
Installation information	
Water connection	15mm connection. Minimum pressure (head) of 0.4 bar (4m). Water to be taken from storage cistern and not from rising main to meet UK water regulations.
Water consumption	14-18 litres per minute
Waste connection	2" BSP threaded flange for connection to 54mm piping, laid to minimum fall of 1 in 7.
Electrical connection	2.5m of mains cable supplied from control box, to be wired into fused isolator switch.
Other features	
Water control	Solenoid valve for automatic water control.
Operator safety	Metal baffle.
Special features	Automatic thermal overload to protect the motor. Manually reversible motor for extended operating life.
Customer options	
-	
Product code details	
F60/305	1 phase 723
F60/300	3 phase 723
Shipping specification	
Packing dimensions (h x w x d)	770mm x 410mm x 510mm
Packing volume	0.161m³
Packing weight (gross/net)	42kg/40kg

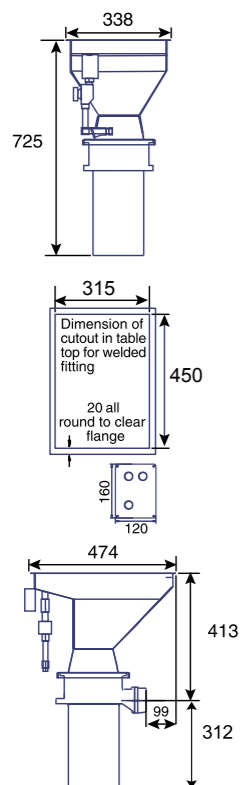
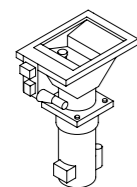

725	
General	
Mounting	Weld into tabling.
Capacity	850 covers per sitting. 400kg of waste per hour.
Dimensions (h x w x d)	725mm x 338mm x 474mm
Cut out dimensions	315mm x 450mm
Electrical information	
Motor	1.1kW (1½HP)
Voltages	230-1-50 400-3-50
Fuse rating	16A - 1 phase 6A - 3 phase
Operator controls	IP65 rated waterproof wall mounted control box. Motor on buttons (clockwise and anticlockwise) and off button.
Installation information	
Water connection	15mm connection. Minimum pressure (head) of 0.4 bar (4m). If using mains water supply specify class A air break with special baffle.
Water consumption	14-18 litres per minute
Waste connection	2" BSP threaded flange for connection to 54mm piping, laid to minimum fall of 1 in 7.
Electrical connection	2.5m of mains cable supplied from control box, to be wired into fused isolator switch.
Other features	
Water control	Solenoid valve for automatic water control.
Operator safety	Metal baffle and time delayed interlock system.
Special features	Automatic thermal overload to protect the motor. Manually reversible motor for extended operating life.
Customer options	
Class A airbreak. Magnetic cutlery saver.	
Product code details	
F60/100	1 phase 725
F60/121	3 phase 725
S99/047**	Class A airbreak
**	Magnetic cutlery saver
Shipping specification	
Packing dimensions (h x w x d)	640mm x 500mm x 880mm
Packing volume	0.161m³
Packing weight (gross/net)	49kg/42kg

** This option must be ordered with the machine.
* All diagram dimensions are in mm

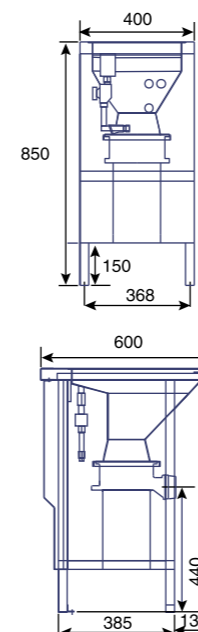
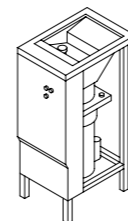

726	
General	
Mounting	Free standing.
Capacity	850 covers per sitting. 400kg of waste per hour.
Dimensions (h x w x d)	850mm x 400mm x 600mm
Cut out dimensions	-
Electrical information	
Motor	1.1kW (1½HP)
Voltages	230-1-50 400-3-50
Fuse rating	16A - 1 phase 6A - 3 phase
Operator controls	IP65 rated waterproof wall mounted control box. Motor on buttons (clockwise and anticlockwise) and off button.
Installation information	
Water connection	15mm connection. Minimum pressure (head) of 0.4 bar (4m). If using mains water supply specify class A air break with special baffle.
Water consumption	14-18 litres per minute
Waste connection	2" BSP threaded flange for connection to 54mm piping, laid to minimum fall of 1 in 7.
Electrical connection	2.5 of mains cable supplied from control box, to be wired into fuse isolator switch.
Other features	
Water control	Solenoid valve for automatic water control.
Operator safety	Metal baffle and time delayed interlock system.
Special features	Automatic thermal overload to protect the motor. Manually reversible motor for extended operating life.
Customer options	
Stainless steel side panels. Class A airbreak. Magnetic cutlery saver.	
Product code details	
F60/200	1 phase 726
F60/221	3 phase 726
E60/010	Stainless steel side panel 726
S99/047**	Class A airbreak
**	Magnetic cutlery saver
Shipping specification	
Packing dimensions (h x w x d)	690mm x 580mm x 1000mm
Packing volume	0.292m³
Packing weight (gross/net)	63kg/48kg

** This option must be ordered with the machine.
* All diagram dimensions are in mm



Harvey Road
Croxley Green
Hertfordshire
WD3 3AX
United Kingdom

Tel: +44 (0)1923 718000
Fax: +44 (0)1923 777273
Email: fwd@imco.co.uk
www.imc-fwd.co.uk

Specifications are subject to change without notice.

4CM/FWDTI/0405UK