

ROUND WAFFLE MAKER WITH AUTO START



Instruction Manual (Installation, Operation & Maintenance)

For your safety and continued enjoyment of this product, always read the instruction book carefully before using.

TABLE OF CONTENTS

A.	SAFETY INSTRUCTIONS	1-2
B.	ASSEMBLY INSTRUCTIONS	3
C.	OPERATING INSTRUCTIONS	3
D.	DESCRIPTION AND SPECIFICATIONS	3
E.	OPERATOR SAFETY INFORMATION	4
F.	SHORT POWER SUPPLY CORD INFORMATION	4
G.	BEFORE USING FOR THE FIRST TIME:	4
H.	BOX CONTENTS	5
I.	PARTS / EXPLODED DIAGRAM	5-6
J.	CHANGING WAFFLE PLATES	6
K.	USING YOUR WAFFLE MAKER	7-8
L.	MAINTENANCE & CLEANING	8

A: SAFETY INSTRUCTIONS

WARNING!

All of the items described must be carefully observed when operating the machine or performing maintenance work.

WARNING!

Do not touch hot surfaces. Use handles or knobs.

WARNING!

To protect against electric shock, do not place cord, plugs, or appliance in water or other liquid.

CAUTION!

Close supervision is necessary when the Waffle Maker is used by or near children.

CAUTION!

Unplug from outlet when not in use and before cleaning. Allow to cool before putting on or taking off parts, and before cleaning the appliance.

CAUTION!

Do not operate any appliance with a damaged cord or plug or after the appliance malfunctions, or has been damaged in any manner.

CAUTION!

Do not use outdoors.

CAUTION!

Do not let cord hang over edge of table or counter, or touch hot surfaces.

CAUTION!

Do not place on or near a hot gas or electric burner or in a heated oven.

CAUTION!

When finished making waffles, set the heat to the lowest setting and remove plug from wall outlet.

CAUTION!

Do not clean container with cleansers, steel wool pads, or other abrasive material.

CAUTION!

When using electrical appliances, basic safety precautions should always be followed to reduce the risk of fire, electric shock, and/or injury to persons.

CAUTION!

It is recommended that you discard the first waffle made on your new Waffle Maker.

CAUTION!



B: ASSEMBLY INSTRUCTIONS

1. Your waffle maker will already be fully assembled upon purchase.
2. Place on a flat sturdy surface.
3. Plug in to a mains socket.

C. OPERATING INSTRUCTIONS

- Plug the power cord into the display panel unit and connect to a 13A, 230V power supply.
- Turn on the mains.
- Turn on the Waffle Maker by pressing the switch on the left hand side of the power unit.
- Set the temperature by pressing the up /down temperature buttons on the display panel.
- The waffle maker is preset to 3 minutes and 30 seconds standard cooking time. If you would like to adjust the cooking time press the up/down time adjust buttons. (NOTE) At the end of the cooking cycle, the timer will revert back to the standard cooking time of 3 minutes 30 seconds.
- To start the waffle maker rotate the plates 180° to the right, the timer will start automatically. Alternatively for reheat function there is a start button on the control panel.

D. DESCRIPTION AND SPECIFICATIONS

- High grade aluminium mould with high thermal conductivity.
- Non stick cooking surface.
- Brushed stainless steel housing.
- Easy removable plates.

E. OPERATOR SAFETY INFORMATION

- This appliance is intended for indoor use only.
- **CAUTION:** To ensure continued protection against risk of electric shock, connect to properly grounded outlets only.

F. SHORT POWER SUPPLY CORD INFORMATION

- A short power-supply is provided to reduce risks resulting from becoming entangled in or tripping over a longer cord. Longer extension cords are available and may be used if care is exercised in their use. If a long extension cord is used, the marked electrical rating of the extension cord should be at least as great as the electrical rating of the appliance. The longer cord should be arranged so that it will not drape over the counter top or tabletop where it can be pulled on by children or tripped over accidentally.
If the supply cord is damaged it must be replaced by one supplied by JM Posner or an authorized agent

G. BEFORE USING FOR THE FIRST TIME

- Remove all packaging materials and wipe cooking plates with a damp cloth. When your waffle maker is new you may notice a slight smoking effect or odour. This is normal with any appliance that heats up and will not reoccur. This does not affect the safety or your appliance.
- It is recommended that you discard the first waffle made on your new Waffle Maker.

H: BOX CONTENTS

1) Waffle maker. 2) User guide. 3) Drip tray. 4) Spanner.

I: PARTS / EXPLODED DIAGRAM

If you require any replacement parts for your waffle maker please contact: **Info@jmosner.co.uk**

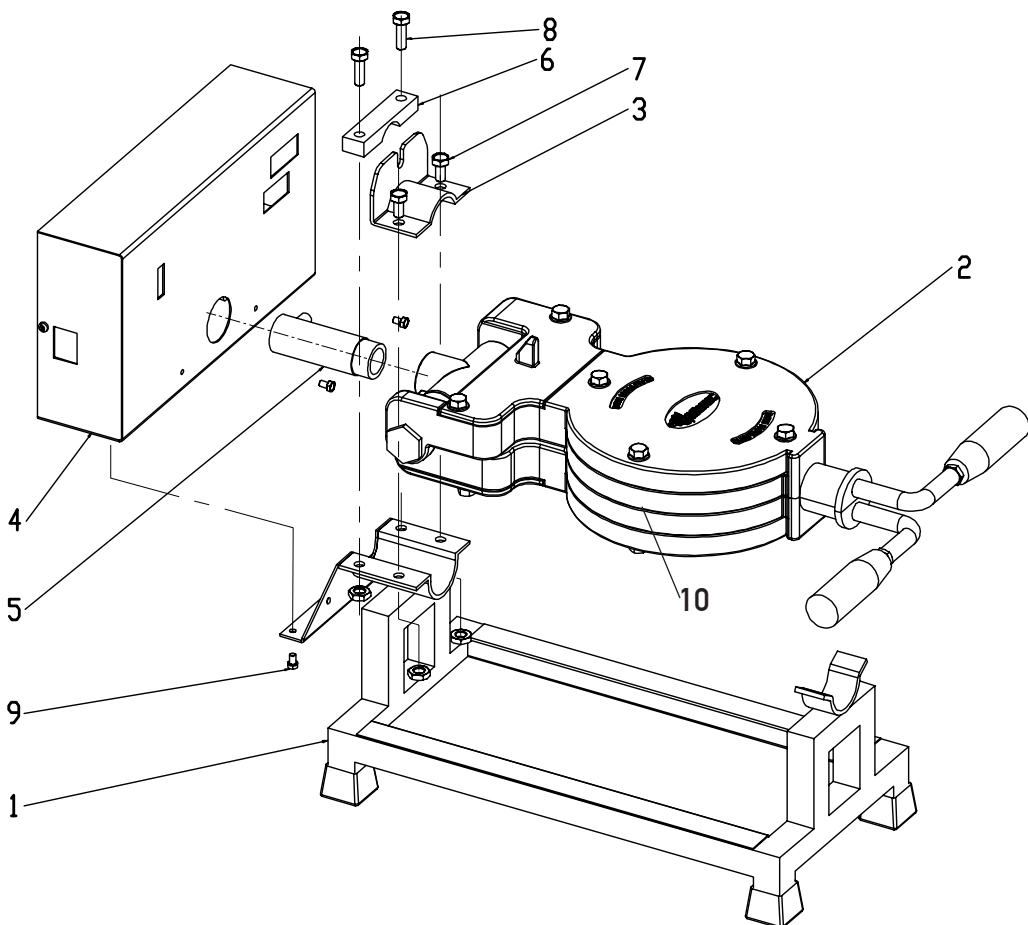

ITEM	DESCRIPTION	STOCK No.	QTY
1	FRAME ASSY	LRW/FAo/D	1
2	PLATE HOLDER BODY ASSY	LRW/PBo/E	1
3	PLATE HOLDER REST	LRW/PRo/19	1
4	PCB BOX ASSY	LRW/PAo/H	1
5	PCB PIPE ASSY	LRW/PPo/I	1
6	PCB PIPE RETAINER	LRW/PRo/25	1
7	HEX HEAD BOLT & NUT M8 X15		2
8	HEX HEAD BOLT & NUT M8 X25		2
9	HEX HEAD BOLT M5 X 8		4
10	WAFFLE PLATES		2

J: CHANGING WAFFLE PLATES

Changing the Waffle plates is a straight forward operation. Ensure the cooking plates are cool, use the spanner provided to unscrew the 4 bolts on the top and 4 bolts on the bottom housing. Remove old plates and replace with new plates, tighten each bolt evenly. Your Waffle Makers new plates are ready for use.

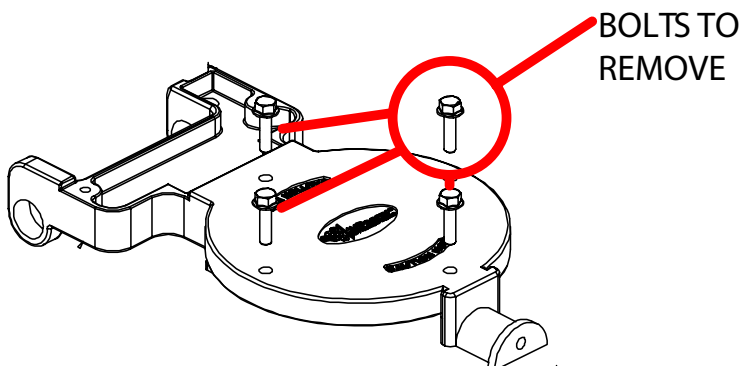

K. USING YOUR WAFFLE MAKER

1. (The temperature numbers on the display is Celsius. If using Fahrenheit, please convert Fahrenheit temperature to desired Celsius) $^{\circ}\text{F} = (^{\circ}\text{C} \times 1.8) + 32$
2. Close the waffle maker and plug into Mains wall outlet. After pressing the ON/OFF switch on the Display Panel you will see the display go on, indicating that the Waffle Maker has power and is ready for preheating. The power will remain ON until you unplug the unit or switch the ON/OFF button again.
3. Set the desired temperature for making your waffles by pressing up or down on the temperature buttons. The temperature will be displayed on the panel.
4. Until the machine reaches the set temperature the "warming" light will be on and once the machine reaches the set temperature the ready light will come on.
5. The waffle maker is preset to 3 minutes and 30 seconds standard cooking time. If you would like to adjust the cooking time press the up/down time adjust buttons. (NOTE) At the end of the cooking cycle, the timer will revert back to the standard cooking time of 3 minutes 30 seconds.
6. When the proper baking temperature is reached the ready light will go off and on periodically, this is normal and is the Waffle Maker keeping to the desired temperature.
7. Pour in just enough waffle mix to fill the lower waffle plate so that the peak areas of the plate are covered. If necessary, use a spatula to spread the waffle mix into the corners of the moulds. **DO NOT** use oil on the plates as this will create carbon which is hard to remove from a non-stick surface.
8. Close the Waffle Maker and immediately turn over 180°, this will automatically start the timer. The Waffle maker will bleep during the cooking process and will stop

bleeping once the cooking cycle is complete. Once ready turn back over 180° so that you can re-open the Waffle Maker and reset the timer.

CAUTION: If the Waffle Maker is opened without re turning 180° the timer will not reset.

CAUTION: Opening too soon will cause unbaked waffles to split, and make them difficult to remove.

9. If you want darker waffles, close the lid and continue cooking, checking every 30 seconds.
10. Remove waffles from the plate with a non-metallic utensil.
11. For best results on your next waffle, wait until the ready light switches off before pouring in new waffle mix.
12. When not using your waffle maker ,but leaving it heated on standby the lid must be kept open to avoid damaging the non stick surface.
13. When you are finished baking, press the ON/OFF switch to turn off the Waffle Maker and unplug the unit from the wall outlet. Leave the Waffle Maker open to allow to cool. After cooling, plates may be wiped clean with paper towels.

L. MAINTENANCE & CLEANING

- **CAUTION:** Be sure to unplug this appliance before cleaning. To protect against electrical shock, do not immerse cord, plug or unit in water or other liquids. After each use, always make sure plug is first removed from wall outlet.
- After cooling any excess crumbs or oils can be wiped away with a paper towel.
- Below the cooking plates there is a removable drip tray for ease of cleaning.
- Wipe the top and bottom housings with a soft cloth. A little metal polish suitable for stainless steel may be occasionally used on the top housing. Do not use any abrasive scouring pads or steel wool, as this will damage the housing finishing.

NOTES

NOTES

Model:
ROUND WAFFLE MAKER
WITH AUTO START

SPECIFICATION:

Height:	310 mm
Width:	315 mm
Depth:	625 mm
Weight:	18 kg
Electrical:	110 / 230V 60 / 50Hz 1200W

www.jmposner.co.uk