

BURCO

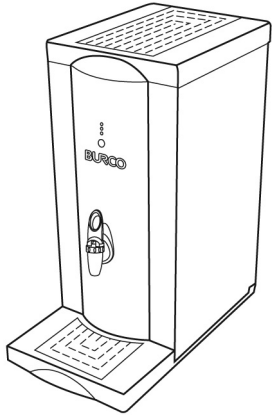

Autofill counter top water boiler



Please read and keep these instructions

For Burco counter top water boilers 76500 (SKU 444448531) and 76502 (SKU 444448533)

Getting the best from your water boiler

.....

- Remove any plastic film from the water boiler before use
- Any water in the water boiler is due to testing and is normal
- The water boiler must be used on a flat level surface
- Boil and discard the water twice before general use



Burco Commercial Catering Equipment

Glen Dimplex Professional Appliances
Stoney Lane, Prescot, Merseyside, L35 2XW
Tel 0844 815 3755 Fax 0844 815 3748
Email info@gdpa.co.uk

www.burco.co.uk



Important safety instructions

The use of any electrical appliance requires following common sense safety rules. Primarily there is danger of personal injury and secondly danger of damage to the appliance and property. These are indicated in the instructions text by the following two conventions:

WARNING: Danger of personal injury.

IMPORTANT: Damage to the appliance.

In addition we offer the following essential safety advice.

General information

Scale build up can damage any appliance which boiling water passes through. Failure to descale your Burco autofill water boiler will invalidate your guarantee.

Before general use it is recommended that the unit is boiled and emptied through the tap twice discarding the water each time. For best taste and to protect your water boiler from limescale Burco suggest you filter the water supply.

Location

- Do not use your autofill water boiler outside.
- All sides must be at least 100mm from any walls.
- On a flat level surface.

Ambient Temperature

This appliance is designed to operate in an ambient temperature between 10°C and 40°C.

Mains lead

- The mains lead should reach from the wall socket the autofill water boiler without straining the connections.
- Do not let the cord hang over the edge of the table or the counter and keep it away from any hot surfaces.
- Do not let the lead run across an open space e.g. between a low socket and table.
- Do not place the autofill water boiler where the mains lead could fall into a sink.

Your safety

WARNING: Extreme caution must be used when moving the autofill water boiler as it is very heavy.

- Do not continue to use the water boiler if the warning lights are flashing, consult advance diagnostics service light warning codes.
- Do not use boiler if it has been damaged in any way.
- Do not place the appliance on or near hot surfaces.
- Do not use accessories or attachments which Burco have not recommended as they can cause hazards.
- Always switch off, empty and disconnect the autofill water boiler before moving the unit.

WARNING: The only parts you should touch behind the front panel are the two red isolation valves and the reset button.

WARNING: To avoid being scalded when the water boiler is in operation or has just been switched off keep hands away from any steam. Be particularly careful not to touch any hot surfaces especially when running the descale programme or when the front/ top panel is removed.

Safety considerations

Important: do not use a water jet to clean this appliance.

Important: do not use this appliance in an area a water jet can be used.

Important: this appliance is not intended for use by persons (including children) with reduced physical, sensory or mental capabilities, or lack of experience and knowledge, unless they have been given supervision or instruction concerning use of the appliance by a person responsible for their safety. Children should be supervised to ensure that they do not play with the appliance.

Important: This appliance is only to be installed in locations where its use and maintenance is restricted to trained personnel.

- To protect against fire, electric shock and personal injury do not immerse cord, plug or water boiler in water or any other liquid.
- Do not tamper with the connector in any way.
- If the mains lead is damaged, it should be discarded and replaced.
- Turn off and unplug when not in use.
- Maintenance other than cleaning and descaling should be carried out by the manufacturer while this product is within guarantee. (Contact our service helpline on 0871 222 2620).
- Warranty is only valid in the UK.

IMPORTANT: This appliance must only be used for heating water.

Electrical requirements

Check that the voltage on the rating plate of your appliance corresponds with your electricity supply which must be A.C. (Alternating Current).

For appliances fitted with a plug

If the socket outlets are not suitable for the plug supplied with this appliance, the plug should be removed and the appropriate one fitted.

WARNING: The plug removed from the mains lead, if severed, must be destroyed as a plug with bared flexible cord is hazardous if engaged into a live socket outlet.

WARNING: This appliance must be earthed.

Should the fuse in the 13A plug require changing, a 13A BS 1362 fuse must be fitted.

IMPORTANT: Installation must be carried out by an appropriately qualified service engineer. Any damage caused by installation by an un-qualified individual will invalidate your warranty.

Fitting a plug

The mains lead of this urn will already be fitted with a BS1363 13A plug. In the event of replacing a fuse, a 13 amp fuse approved by ASTA or BSI must be used. If the plug is not suitable for your socket then the plug must be cut off and disposed of safely. An appropriate plug should be fitted as follows:

IMPORTANT: The wires in the mains lead are coloured in accordance with the following code:

Green-and-Yellow - Earth

Blue - Neutral

Brown - Live

The wire, which is coloured green and yellow, must be connected to the terminal in the plug which is marked with the letter E or the earth symbol or coloured green or green and yellow. The wire, which is coloured blue, must be connected to the terminal which is marked with the letter N or coloured black or blue. The wire, which is coloured brown, must be connected to the terminal which is marked with the letter L or coloured red or brown. Make sure that the connections are tight and that there are no loose strands of wire and no insulation trapped under the terminals. Tighten the

clamp in the plug making sure that it grips the outer covering of the cord. In a 13A (BS 1363) fused plug, fit a 13A fuse. Tighten the plug cover securely.

If you are in any doubt, consult a qualified electrician.

IMPORTANT: The supply cord on this appliance is of a special type. If replaced, only a Burco supply cord must be used. The supply cord may become warm when the appliance is in use.

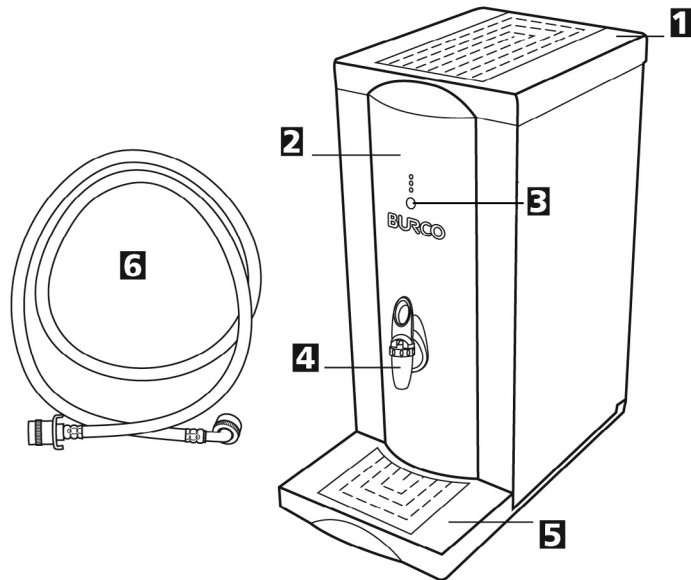

Features

- 1 Removable lid (Easy access for descaling)
- 2 Removable front cover
- 3 On/Off switch
- 4 Safety locking tap
- 5 Drip tray
- 6 Hose for connection to drinking water

Preparation

- 1 Remove any plastic film from the water boiler and wipe over all surfaces with a clean cloth.
- 2 Check that the voltage on the rating plate of your appliance corresponds with your electricity supply which must be A.C. (Alternating Current).
- 3 Before using it is recommended that the water boiler is boiled twice, discarding the water each time.

Check list

Before starting installation check that you have the following parts:

- Autofill water boiler
- Drip tray
- Food safe hose

Connecting to a water supply

Your water boiler has been supplied with a suitable hose **6** for connection to a drinking water supply. The water supply must have a pressure not exceeding 1000 kilopascals (10 bar) and no lower than 25 kilopascals (0.25 bar). If your water pressure exceeds this, a suitable pressure reduction valve will need to be fitted.

Please ensure that you follow the bye-laws of the water council when installing this product.

Burco cannot be held responsible for water boiler malfunction if the water supply pressure does not confirm as above. If in any doubt consult your water supply company.

The hose supplied with the water boiler is manufactured from materials which have been approved for drinking water and is rated at 10 bar at ambient temperature. It is therefore recommended that the water boiler is only connected to a cold water supply. Your guarantee could be invalidated and water contamination may occur if a hose not supplied by Burco is used. Please note that washing machine hoses are not suitable for use on this water boiler.

Connection to mains water supply

Your autofill water boiler can be set up so that the mains water connection can either enter your water boiler at the back or the bottom of the unit.

To set up connection from back of unit:

- Using a screw driver remove blanking plate from back of unit **A**.
- Attach supplied water connection fitting to water inlet (screw fitting) and when secure attach the pipe **B**.
- Tightly attach other end of water connection hose to mains water supply.
- Ensure all pipes are suitably insulated to prevent water supply from freezing.
- If rear overflow is required see instructions below on how to set this up at this point.

To set up connection from bottom of unit:

- Using a screw driver remove blanking plate from back of unit **A**.
- Attach supplied water connection hose to water inlet with the elbow joint connection on the hose (screw fitting) **C**.
- Tightly attach other end of water connection hose to mains water supply.
- Replace blanking plate.

Overflow

Connecting rear overflow

An air gap of 200mm from the connection point must be provided. Failure to provide this air gap will cause an air lock and stop the water discharging in event of an overflow.

IMPORTANT: For rear overflow connection a 14mm internal diameter hose or a 15mm internal diameter hose with a pipe clip must be used. While every reasonable precaution is taken to prevent an overflow, Burco cannot be held responsible for any damage caused as a result of incorrect installation or blockage of the overflow.

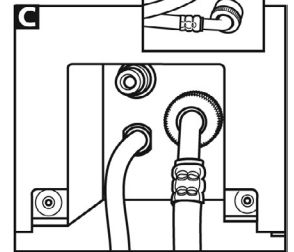
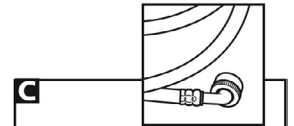
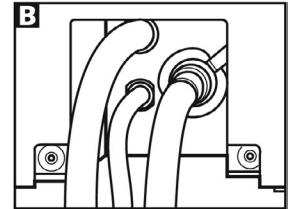
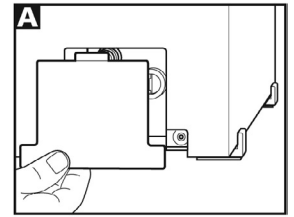

- Attach a suitable 14mm internal diameter or 15mm internal diameter hose with a pipe clip, to outlet connection. (Hose not supplied)
- Attach other end of outlet hose to mains drain.
If connection to the bottom of the water boiler is desired now replace the blanking plate at the back of the unit, using screw driver to tighten in place.

Connecting your drip tray to the mains drain

You are able to connect your drip tray to a mains drain inside the counter your autofill water boiler is sitting on. To do this you will require suitable hose and fittings.

You will need to follow the below procedure:

- Check that you have a connection to a suitable mains drain underneath your work top.
- Position your autofill water boiler on your countertop. Remember to leave a space at the back of the unit if you are connecting the unit to the mains water supply/ connecting your overflow to protrude from the back of the unit.
IMPORTANT: Check that the hose you have is the correct length to reach between mains drain connection and the bottom of the drip tray.
- When you are happy with the boiler position, remove the drip tray from your autofill water boiler, take off the stainless steel drip tray cover.
- If you turn over the remaining section of the drip tray you will see in the centre a raised circle, drill a hole through the centre of this circle. (It is suggested that the drip tray is placed on a surface which you do not mind damaging before you drill the hole, in case the drill goes through the hole and damages the surface underneath.)
IMPORTANT: The hole you drill will need to be large enough to accommodate the fitting you have purchased.
- Replace the drip tray on your autofill water boiler (still in desired position).
- Do not replace the stainless steel cover so that you are able to mark the position of the hole on the work surface with a suitable marker.
- Remove drip tray and drill hole through work surface in marked location. Before doing this ensure that there is nothing underneath your work top, which you may damage when drilling through the work top.
IMPORTANT: The hole you drill will need to be large enough to accommodate the hose/ fittings you have purchased.
- Attach hose at mains drain and pull through hole in work surface.
- Leaving enough spare length in the pipe to allow drip tray to be connected, attach connecting fitting to the end of the hose protruding through the work surface. Push connecting valve into the bottom of the drip tray.
- Replace drip tray and stainless steel cover.

Using

IMPORTANT: Always ensure unit is connected correctly to a water supply and the supply is on before switching the appliance on.

Operating

Safety tap.

- 1 The tap is locked or unlocked by twisting it so that the closed or opened padlock symbol is lined up with the white dot on the tap body.
General operation.
- 2 There are two open positions, one self- holding so that the tap remains open, and the other self-closing so that the tap closes as soon as the lever is released. To change the tap position, turn the tap lever through 180°.
- 3 Open the tap by depressing the tap lever into the horizontal position.
- 4 Close the tap by returning the lever to a vertical position.

After use

Switch off and isolate from supply. Water may be left in the water boiler when it is not in use for short periods, for longer periods it should be emptied and cleaned out.

Protective cut-out

WARNING: The only parts you should touch behind the front pane are the two red isolation valves. Touching any other part will put you in danger of receiving an electric shock.

WARNING: The protective cutout is only to be reset by a qualified service engineer.

The heating element is fitted with a manual resettable thermal cutout which protects the water boiler from damage if it were to overheat **D**. If your appliance fails to heat up and/or appears “dead” when switched on, try the following:

Check the water boiler is plugged in to the mains and switched on both at the plug/spur and the front of the unit. If this does not resolve the problem switch off and disconnect the appliance. Remove the front panel (see instructions below) and remove internal cover below the water tank. Reach in carefully and on the underside of the element, between the two terminals you will see a reset button.

Press this upwards and the thermostat will reset (click). We would always recommend descaling the water boiler after resetting the thermostat as scale build up is the most common reason for the safety thermostat operating.

If the safety thermostat activates repeatedly, even after descaling please contact the customer helpline.

After resetting the cut-out replace the front panel and top plastic lid. Reconnect to the mains and switch on at plug/spur and on the front of the unit. If the problem persists please contact Burco customer helpline.

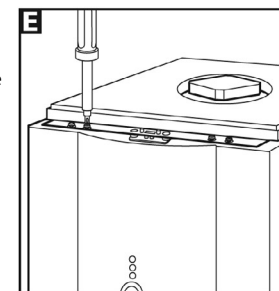
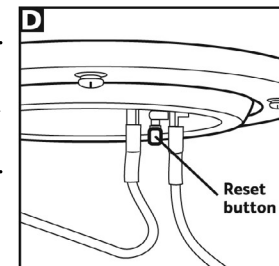

Cleaning

WARNING: Disconnect from the electrical supply before cleaning and allow the water boiler to cool.

IMPORTANT Do not immerse the water boiler in water or any other liquids and take care to keep water away from the mains lead and connections. There are two ways in which you will need to clean your autofill water boiler:

Externally; to do this follow the external cleaning guidelines below.

Internally; to do this follow the Easy Descale Procedure (see page 8).

IMPORTANT Do not use any abrasive cleaning fluids or materials.

External cleaning guidelines

WARNING: Always disconnect the plug from the mains and allow to cool before cleaning.

To clean, wipe the outside of your autofill water boiler with a damp cloth. It is recommended that this is done daily. Stubborn stains may be removed using a good stainless steel cleaner or non-abrasive cleaner.

Hard to reach areas should be cleaned using a small bristle brush and mild cleaner.

IMPORTANT: Do not use abrasive cleaners on your water boiler as this could scratch the finish of your water boiler.

To remove front panel of unit

- Remove black plastic lid **F**.
- Using screw driver remove two retaining screws
- Lift front panel slightly to disconnect front panel at top of the curved front panel so that hole for the tap goes over the lower part of the top and lift vertically over the rest of the tap **F**.
- Pull front panel forward while lifting hole for tap over base tap fitting.
- Lift front panel over top of tap fitting.



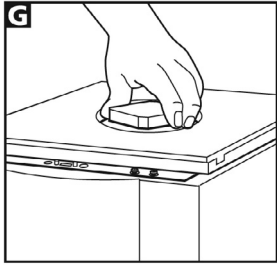

WARNING: When replacing the front of panel, ensure that wires do not get trapped between tap and front panel.

Easy descale procedure

When to descale

Burco recommend that its appliances are descaled as part of the regular planned preventative maintenance schedule at least every 3 months. This may be required more periodically if the appliance is being operated in a hard water area. Failure to descale the appliance periodically could cause the appliance to cut out to protect the element in the event of excessive scale build up. If the appliance stops heating and all lights on the front of the appliance go out, the first thing you should do is to complete the following descale procedure.

Descaling

- 1 Switch off the appliance on the front panel.
- 2 Remove lid and prepare for descale.
 - Remove the black plastic lid by lifting up. You may need a screwdriver to lever the lid off the stainless casing.
 - Unscrew the large, square, black cap (twist anticlockwise).
- 3 Drain down tank.
 - Take front panel off (see instructions on page 7)
 - Drain the tank through the normal operating tap, this will ensure there is still a small volume of water in the tank.
- 4 Pour the descale liquid or powder into the tank.
- 5 Switch on the appliance and allow to fill and boil, activating the descale solution. This process will take approx 40 minutes.
- 6 Switch off the appliance.
- 7 Drain down the tank completely using the tank drain down valve. Connect a hose (supplied) to the drain valve and drain into a vessel or drain to dispense of the water.
- 8 **CLOSE THE DRAIN VALVE!**
- 9 Fill the tank with fresh water through the plastic cap on top of the unit and drain the tank again.
- 10 Reassemble your appliance, refitting the front cover, tank cap and lid. Your appliance will now operate normally.

In hard water areas where a large build up of scale has formed, you may need to remove the tank lid and physically scrape the scale from the tank and level sensing probes. If this is required, ensure care is taken not to damage the level sensing probes.

Tap failure

- Scale build up can cause your tap to drip when it is in a closed position. If your tap should fail to operate follow the procedures below:
- Remove front panel of unit. (See procedure on page 7).

WARNING: The only parts you should touch behind the front panel are the two red isolation valves. Touching any other part will put you in danger of receiving an electric shock.

- Isolate tap by turning tap isolation valve clockwise.
- Unscrew the top of the tap from the body of the tap.
- If scale is present (white/yellow chalky substance), wipe, scrape and break the scale away from the rubber flexible seal and also from the sealing surface inside the body of the tap.
- Replace top of tap, screwing it firmly back into the base. Open the isolation valve behind tap. If dripping has stopped replace front panel and follow descale process (see above). If tap continues to drip call the Burco customer helpline. **IMPORTANT** Failure to de-scale will invalidate your guarantee.

Trouble shooting

Indicator light warning codes

INDICATOR LIGHT	CAUSE/PROBLEM	ACTION
Green indicator light.	Power on.	
Amber ready light.	Flashes when heating up On constantly when up to temperature.	
All lights out.	Unit may need de-scaling, be over boiling or boiled dry	Contact Helpline.

PROBLEM

Tap is dripping when closed	See 'tap failure' guidelines on page 8.
-----------------------------	---

Helpline 0871 222 2620

Replacement Parts

IMPORTANT: This product has no 'user' serviceable parts.

IMPORTANT: Installation must be carried out by an appropriately qualified service engineer. Any damage caused by installation by an unqualified individual will invalidate your warranty.

Genuine replacement Burco parts must only be fitted by a qualified service engineer. If generic non-Burco parts are fitted you may stop your autofill water boiler operating safely and in the most efficient manner and may invalidate your warranty.

Helpline 0871 222 2620

If you have any difficulty with your appliance, please check the items on the list below:

- Does your autofill water boiler have power going into the unit?
 - Have you tried descaling your autofill water boiler?
 - Have you pressed reset button?
- If you are still having trouble with your appliance please don't hesitate to call us. Please try to have your product to hand and have the following information ready to enable us to deal with your query quickly:
- Name of the product.
 - Model number as shown on rating plate, located on the side of the unit.
 - Serial number as located on the rating plate, located on the side of the unit.

Guarantee

This water boiler is guaranteed for a period of 12 months from the date of purchase against defective materials or faulty workmanship. This guarantee is given subject to the water boiler being used in accordance with the instructions on the supply voltage marked on it and to the usual fair wear and tear conditions. The guarantee does not cover consequential damage arising out of any failure acceptable under guarantee, nor does it cover damage resulting from misuse, accident or unauthorised alterations to the water boiler.

This guarantee, in no way diminishes the buyer's statutory rights.

Burco products are intended for commercial use as detailed in these instructions.

Burco has a policy of continuous improvement in product quality and design. The Company, therefore, reserves the right to change the specification of its models at any time.



For electrical products sold within the European Community. At the end of the electrical products useful life it should not be disposed of with household waste.

Please recycle where facilities exist. Check with your Local Authority or retailer for recycling advice in your country.

BURCO

CP76500MUK rev 2 08/08